

JOHN R. BEHLING CO.  
PLAT OF SURVEY

The West 66.00 feet of the East 132.00 feet of the South 330.00 feet of the West 990.00 feet of the North-west 1/4 of Section 13, Town 3 North, Range 21 East, excepting the South 45.00 feet which is reserved for highway purposes.

The above described tract is also known as the West 1/2 of Parcel no. 68 in Fountain acres (unrecorded plat)

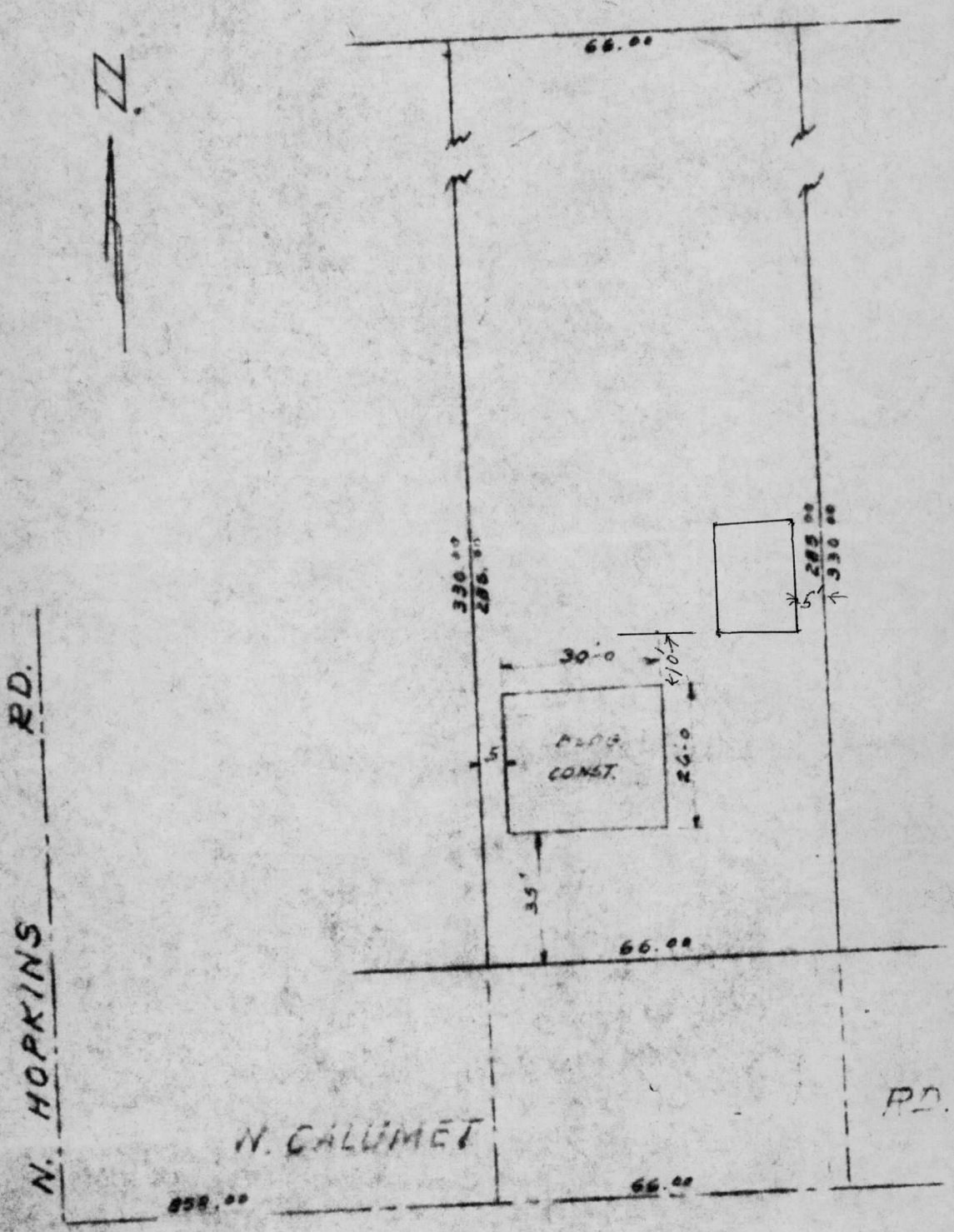

STATE OF WISCONSIN )  
 )SS.  
 COUNTY OF MILWAUKEE )

I, John R. Behling, do hereby certify that I have made the above survey according to official records; that the survey of the lot and the information relative to all buildings located on said lot, all as shown on above survey, is true and correct as indicated and marked on the above map; that the photograph attached hereto is of the building as shown above.  
 Milwaukee, Wisconsin - Nov. 28 1951

RECEIVED  
 3/15/67  
 John R. Behling  
 Surveyor